

SOWPARNIKA



# WHISPERING PETALS

[www.sowparnikawhisperingpetals.com](http://www.sowparnikawhisperingpetals.com)





## When the City Steps Back, Life Steps In

A rare kind of quiet, within *Bangalore*.  
Where *Sparrows* return, *petals bloom* in calm gardens,  
and the city finally feels like home. \_\_\_\_\_



## A Place Where Hope Begins

*Dreams* don't appear in grand gestures;  
they begin quietly,  
in a small seed tucked into the soil,  
in the hope you carry in your heart,  
in the belief that tomorrow can be better.



*Whispering Petals* begins in that same quiet promise,  
a place crafted for people who dream  
not just of owning a home,  
but of building a life that feels full, warm, and *meaningful*.

---



## Living Moments

Here, everyday moments turn into rituals,  
rituals turn into memories,  
and memories slowly weave a story,  
Your story.

## *Whispering Petals*

becomes the keeper of everything you cherish.

---





## Rising Dreams

*Three towers* rise gracefully here,  
reaching up to 19 floors,  
as if gently holding your dreams closer to the sky.

From this height, mornings feel brighter,  
evenings feel calmer,  
and the world stretches out before you  
in quiet, *comforting views*.

These towers stand strong,  
But what they hold inside  
is even stronger,  
the stories of *the families*  
who will soon call this place home.





## LEGENDS

- |   |                          |
|---|--------------------------|
| 1. Grand Entry Portal                             | 14. Outdoor Gym          |
| 2. Sunset Deck                                    | 15. Yoga/Meditation Lawn |
| 3. Padel Court                                    | 16. Amphitheatre         |
| 4. Mini Futsal Court                              | 17. Reflexology Zone     |
| 5. Pickleball Court                               | 18. Leisure Lawn         |
| 6. Volleyball                                     | 19. Party Lawn           |
| 7. Basketball Practice Post                       | 20. Koi Pond             |
| 8. Box Cricket                                    | 21. Sunrise Deck         |
| 9. Landscaped Garden                              | 22. Walking Track        |
| 10. Giant Board Games<br>(Ludo, Snakes & Ladders) | 23. Swimming Pool        |
| 11. Kidsplay Area                                 |                          |
| 12. Maze Garden                                   |                          |
| 13. Senior Citizen Plaza                          |                          |







SOWPARNIKA

SOWPARNIKA



# PROJECT HIGHLIGHTS

## SITE DETAILS:

SITE AREA	8 ACRES 5 GUNTAS
SITE LOCATION SY.NO	75/4,75/6,75/7,75/9 OF DODDAHULLUR VILLAGE & 14/2 OF YALACHANAYAKANAPURA,KASABA HOBLI, HOSKOTE TALUK, BANGALORE RURAL DISTRICT.

## FLOORS & HEIGHT:

TOTAL NO. OF FLOORS	TOWER 1: 2 BASEMENT (PARKING)+ GROUND + 19 FLOORS
	TOWER 2 : 2 BASEMENT (PARKING)+ GROUND + 19 FLOORS
	TOWER 3 : 2 BASEMENT (PARKING) + GROUND + 19 FLOORS
BUILDING HEIGHT	59.95M <60M





# PROJECT HIGHLIGHTS

## UNIT:

TOTAL NO. OF UNITS - 762
TOTAL NO. OF UNITS PER FLOOR - 39
UNITS ON GROUND FLOOR - 24
UNITS ON FIRST FLOOR - 36

## TOWER 1

TYPES OF UNIT	3 BHK	2 BHK	1 BHK	TOTAL
SALEABLE AREA IN SQFT	1187-1326	1036-1073	568	-
UNITS PER FLOOR	10	6	1	17
TOTAL UNITS	200	118	20	338

## TOWER 2

TYPES OF UNIT	3 BHK	2 BHK	1 BHK	TOTAL
SALEABLE AREA IN SQFT	1187-1326	1036-1073	568-604	-
UNITS PER FLOOR	7	4	2	13
TOTAL UNITS	133	75	38	246

## TOWER 3

TYPES OF UNIT	3 BHK	2 BHK	1 BHK	TOTAL
SALEABLE AREA IN SQFT	1187-1315	1063	-	-
UNITS PER FLOOR	6	3	-	9
TOTAL UNITS	120	58	-	178

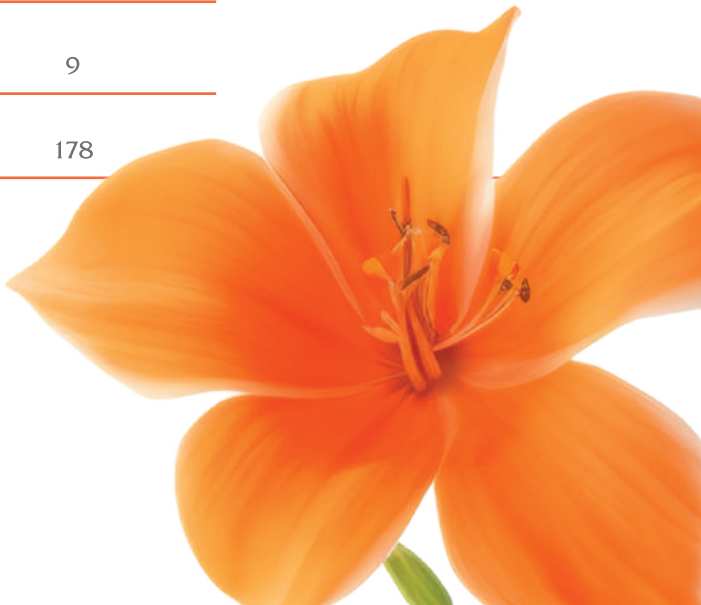

# GROUND FLOOR

## BUILDING - 1 (Tower 1 & 2)



## BUILDING - 2 (Tower 3)





# FIRST FLOOR

## BUILDING - 1 (Tower 1 & 2)



## BUILDING - 2 (Tower 3)



# TYPICAL FLOOR

## BUILDING - 1 (Tower 1 & 2)

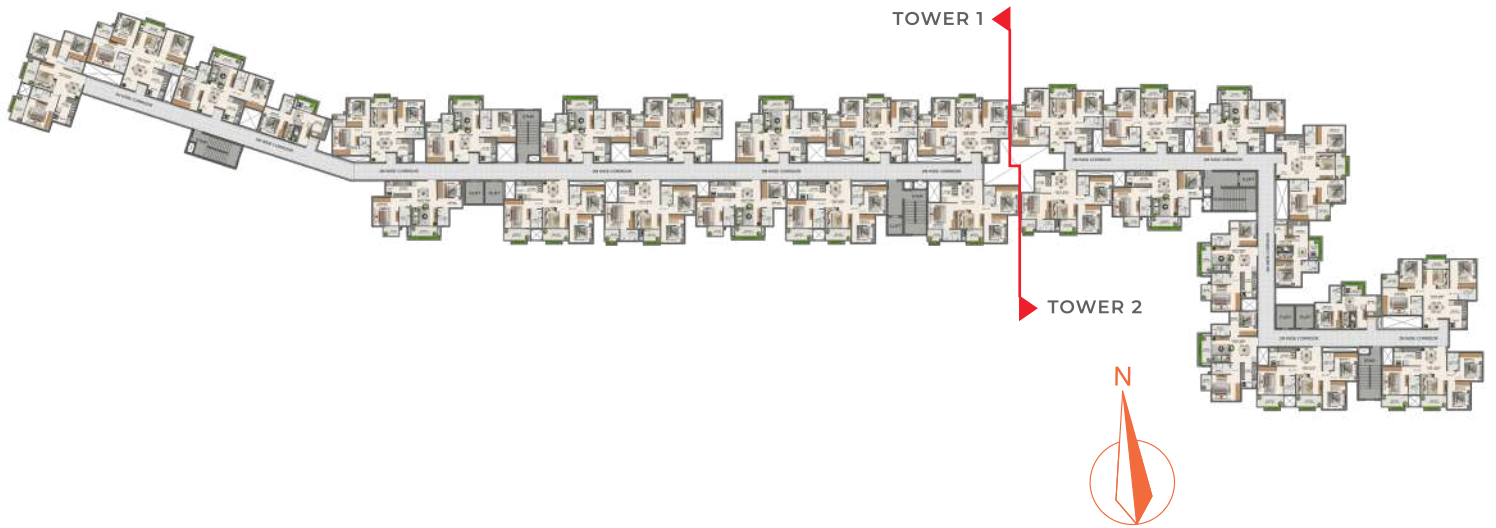

## BUILDING - 2 (Tower 3)





# KEY PLAN

## BUILDING Tower - 1, 2 & 3

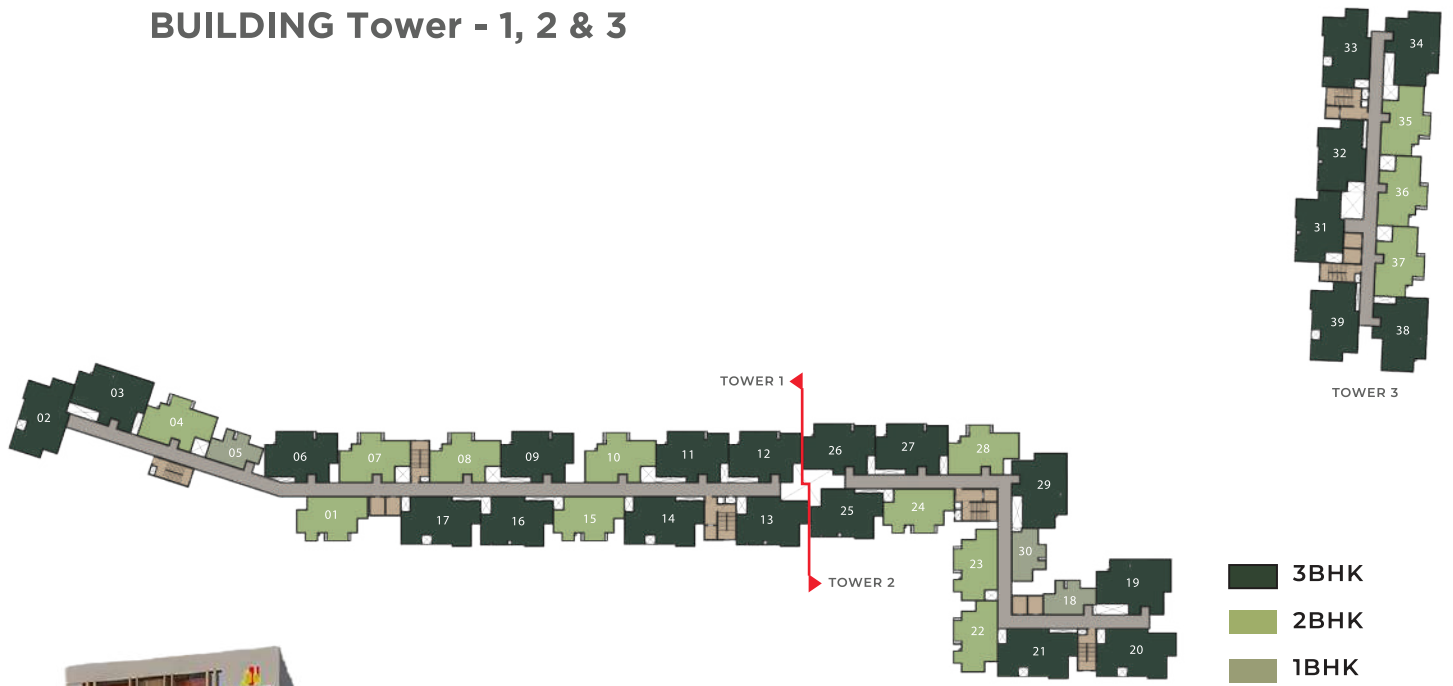

# AMENITIES



GRAND ENTRY  
PORTAL

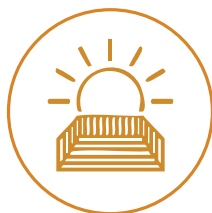

SUNRISE / SUNSET  
DECK



PADEL COURT



MINI FUTSAL  
COURT



PICKLEBALL



VOLLEYBALL



BASKETBALL  
PRACTICE POST



BOX CRICKET







**LANDSCAPED  
GARDEN**



**GIANT BOARD  
GAMES**



**KIDSPLAY  
AREA**



**INDOOR GAMES**



**MAZE GARDEN**



**SENIOR  
CITIZEN PLAZA**



**OUTDOOR GYM**



**YOGA / MEDITATION  
LAWN**



**AMPHITHEATRE**



**REFLEXOLOGY  
ZONE**



**LEISURE LAWN**



**KOI POND**



**WALKING TRACK**



**SWIMMING POOL**



**BADMINTON COURT**



**PLACE FOR  
DOCTORS CLINIC**



**MULTIPURPOSE HALL**



**GYM**



**PLACE FOR  
CONVENIENCE STORE**



**PARTY LAWN**

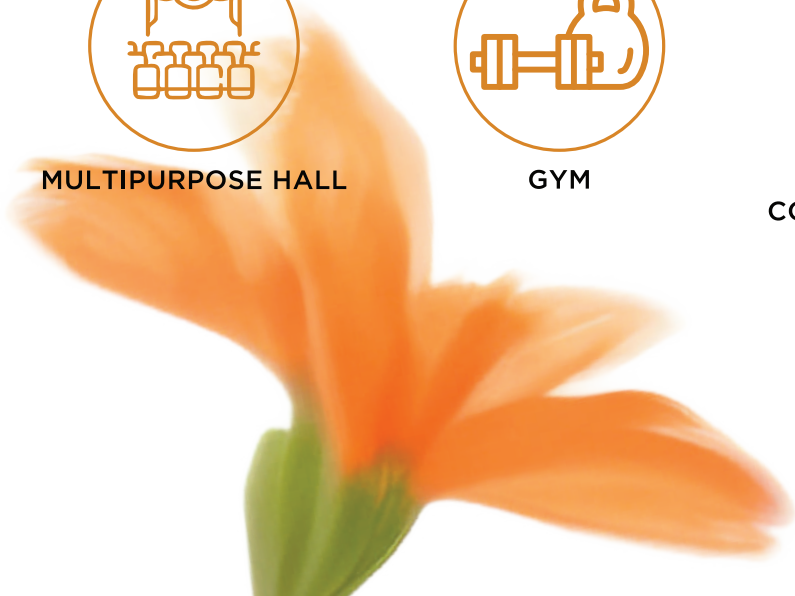







# UNIT PLANS



TYPE 1 - 3BHK EAST FACING

AREA : 1326 SQ FT

TOWER 1- 03 | TOWER 2- 19

PRIVATE TERRACE AT  
GROUND FLOOR UNIT : G03\* - 386 SQFT



TYPE 2 - 3BHK NORTH FACING

AREA : 1311 SQ FT

TOWER 1- 14, & 17 | TOWER 2- 20, & 21

PRIVATE TERRACE AT GROUND FLOOR  
UNIT : G14\* - 108 SQFT | G17\* - 97 SQFT



# UNIT PLANS



TYPE 3 - 3BHK EAST FACING

AREA : 1211 SQ FT

TOWER 1- 06, 09, 11, & 12

PRIVATE TERRACE AT  
GROUND FLOOR UNIT : G06\* - 108 SQFT,  
G09\* - 178 SQFT, G11\* - 233 SQFT,  
G12\* - 256 SQFT



TYPE 3A - 3BHK EAST FACING

AREA : 1223 SQ FT

TOWER 2- 26, & 27





# UNIT PLANS



TYPE 4 - 3BHK NORTH FACING

AREA : 1187 SQ FT

TOWER 1- 13, & 16 | TOWER 2- 25

PRIVATE TERRACE AT GROUND FLOOR

UNIT : G13\* - 87 SQFT | G16\* - 80 SQFT



TYPE 5 - 3BHK NORTH FACING

AREA : 1315 SQ FT

TOWER 2- 29 | TOWER 3- 34, & 38

PRIVATE TERRACE AT GROUND FLOOR

UNIT : G34\* - 192 SQFT | G38\* - 74 SQFT



# UNIT PLANS



# UNIT PLANS



TYPE 1 - 2BHK EAST FACING

AREA : 1073 SQ FT

TOWER 1- 04, 07, 08, & 10 | TOWER 2- 28

PRIVATE TERRACE AT GROUND FLOOR

UNIT : G04\* - 202 SQFT | G08\* - 231 SQFT  
| G10\* - 303 SQFT



TYPE 2 - 2BHK NORTH FACING

AREA : 1036 SQ FT

TOWER 1- 01, & 15 | TOWER 2- 24

PRIVATE TERRACE AT GROUND FLOOR

UNIT : G01\* - 164 SQFT | G15\* - 202 SQFT





# UNIT PLANS



# UNIT PLANS



TYPE 1 - 1BHK EAST FACING

AREA : 568 SQ FT

TOWER 1- 05 | TOWER 2- 18

PRIVATE TERRACE AT GROUND FLOOR

UNIT : G05\* - 202 SQ FT



TYPE 2 - 1BHK WEST FACING

AREA : 604 SQ FT

TOWER 2- 30







## 1. Structure :

- Core wall and Shear wall – Monolithic construction with usage of best quality aluminium modular shuttering system.



## 2. Flooring :

- Living, Dining, Kitchen and Bedrooms – Vitrified tiles of reputed make.
- Toilet flooring – Matt-finish vitrified tiles of reputed make.
- Toilet dadoing up to 7 feet – Matt-finish vitrified tiles of reputed make.
- Kitchen dadoing above the counter up to height of 2 feet – Ceramic-glazed tiles of reputed make (only supply)
- Balcony – Anti-skid ceramic tiles of reputed make.
- Common Area – Matt-finish Vitrified tiles of reputed make.



## 3. Kitchen :

- Granite top & Stainless steel single bowl with drain board sink of reputed make (only supply).
- Provision for Chimney in kitchen.
- Utility area equiped with centralized RO water inlet.



## 4. Toilet :

- Sanitary fittings - Wall mounted EWC, Counter top wash basin of reputed make.
- CP fittings- Shower spout, Diverter, Shower head, health faucet of reputed make.
- Provision for geyser and Exhaust fan in toilets.



## 5. Door :

- Main Door -Super steel frame & Dual door of reputed make.
- Internal doors - Super steel frame & Single door of reputed make.
- Toilet doors - FRP door.
- Balcony doors – UPVC glazed shutter with mosquito mesh.
- Fire rated steel doors for fire exit.





## 6. Windows :

- UPVC windows with glazed shutters and mosquito mesh.
- M.S. safety grill for all the windows.



## 7. Electrical :

- Modular switches & sockets of reputed make.
- ELCB and MCB with independent EB meter of approved make.
- Good quality concealed copper wiring of approved make.
- Provision for Washing Machine point.
- TV points are provided in Living & Master Bedroom.



## 8. Power Backup :

- 100 % power back up for common areas.
- 1 KW power backup for 3BHK & 2BHK and 0.75KW for 1 BHK



## 9. Paint :

- Internal : Walls & Ceilings in Emulsion of reputed make.
- External : Water proof Emulsion of reputed make.
- All Raillings : Enamel paint of reputed make.



## 10. Elevator :

- Lifts of Reputed make.



## 11. Air conditioning :

- Provision for fixing AC in Living cum Dining and all Bedrooms.











# SOWPARNIKA

Delivering Happiness

Sowparnika Group stands for a vision where every aspiring family can own a home they are proud of.

Sowparnika has been redefining affordable housing in South India with a focus on quality, transparency, and timely delivery. With over two decades of experience and projects across Karnataka, Kerala, and Tamil Nadu, Sowparnika has become a trusted name for first-time homebuyers. Every project reflects the promise of creating not just houses, but homes where aspirations bloom.

## Achievements & Awards



### Delivered 66+

landmark projects across South India, setting new benchmarks in quality and design.



### 10,000+

Happy Families, creating vibrant communities filled with trust and satisfaction.



### First choice

for aspiring homeowners in Bengaluru and beyond, building a legacy of reliability and value.



### Affordable luxury

housing recognized with multiple awards for excellence and innovation.

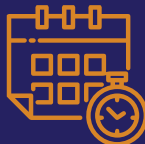

### On-time delivery

and unwavering customer trust have become the hallmarks of our reputation.





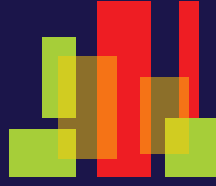

# SOWPARNIKA

Delivering Happiness

## SITE ADDRESS

SY. NO. 14/2 of Yalachanayakanapura Village and  
Sy. No. 75/4, Sy. No. 75/6, Sy. No. 75/7 & Sy. No. 75/9 of Doddahulluru Village,  
Kasaba Hobli, Hosakote Taluk, Bangalore Rural District - 562114

## CORPORATE OFFICE

No. 750, 1st Main Road, AECS Layout C-block, Kundalahalli,  
Marathahalli, Bangalore - 560 037, India.

———— [www.sowparnika.com](http://www.sowparnika.com) ————

RERA: PRM/KA/RERA/1250/304/PR/301025/008211

 +91 85 85 85 0999