



**SOWPARNIKA**  
Delivering Happiness



PERMIT NO. B1-5882/2016

# NATURA

Amala Nagar, Thrissur

A Home, Beyond It's Four Walls

## We deliver Happiness. Everyday.

Sowparnika is not just any other real estate company. It is probably the first to bring the concept of Lean Six Sigma across all the processes in the company. Which means you'll get your projects delivered on time. You will get better value considering that we maximise efficiencies and we pass the benefits on to our customers. At Sowparnika we believe in sensible pricing. Our commitment is based on the strongly grounded principles of Transparency, Customer Satisfaction and Teamwork. We have 6000+ satisfied customers, 35+ completed projects, 35+ ongoing projects, 50+ lakh sq.ft developed, 50+lakh sq.ft under development and a strong presence in 3 states namely Karnataka, Tamil Nadu and Kerala. And we have only just begun.

## Specifications

### Foundation:

RAFT or MAT Foundation.

### Structure:

RCC framed structure wall made of superior quality blocks.

### Doors:

Hardwood entrance door, molded internal door & flush doors toilets.

### Windows:

Powder coated (3 track) Aluminium fabricated windows with glazed shutters & safety grills.

### Flooring:

Vitrified Tiles For Living, Dining and Bedroom Area, Ceramic Tiles for Kitchen and Balcony.

### Toilets:

Anti-skid ceramic tiles for flooring, glazed tiles for wall up to door height, washbasin, EWC (white), hot & cold water mixer with overhead shower & CP fittings.

### Kitchen:

Granite and Sink (Supply Only)

### Electrical:

Concealed conduits wiring with fire resistant cables. Elegant modular switches, controlled by ELCB & MCB with independent KSEB meter.

### Generator:

Generator backup for elevators, common lighting, water pumps & apartment through limiter switch.

### Elevators:

2 Passenger Lift and 1 Service Lift.

### Air Conditioning:

Provision For Fixing AC in Master Bedroom.

### Painting:

Internal - 2 coats acrylic putty, 1 coat cement primer & 2 coats of emulsion paint,  
External - 1 coat of external cement primer & 2 coats of external paint.

## Amenities

- Swimming pool
- Landscaped garden
- Visitor lobby
- Children's play area
- Intercom connection with security cabin
- Unisex gym
- Indoor games
- Waste management system
- Sewerage treatment plant
- Rainwater harvesting
- 24 Hours security
- 24 Hours power backup for common area
- Covered car parking
- Drivers/Servant toilet facilities.

# NATURA

## Project Surrounded by Lush Green

Escape the mad rush and traffic jams. Escape cramped living spaces. Escape the concrete jungle. Escape your routine. Escape reality... and set foot in a world that's apart from the one you're used to – **WELCOME TO NATURA!**

Tucked away in a quaint and serene landscape, untouched by pollution and the hustle-bustle, with just 74 flats on offer, you will find a perfect balance between the privacy of independent homes and the comforts and conveniences of community living.

Natura homes are surrounded by lush greenery, sprinkled with the vibrant colors of blooming flowers. A perfect paradise for someone who desires to be nurtured by the finest features that nature has to offer.



## Site Analysis

Natura is located in Amala, just 20 minutes from Thrissur. Thrissur is the cultural capital of Kerala. Thrissur is major financial and commercial hub of Kerala. It is also an educational hub.

## Surrounding Infrastructures

### Schools

Kendriya Vidyalaya  
Sree Sarada Girls School  
Rashtriya Sanskrit Sansthan  
SRKGMHSS

### Hospitals

Amala Hospital  
Amala Cancer Research Center

### Banks

State Bank of India  
Union Bank of India  
Adat Farmers Service  
Co-operative Bank  
South Indian Bank

### Nearest Tourist Places

Vilangan Hill Park  
Vilangan Trekking Point  
Sobha City Mall

## Location

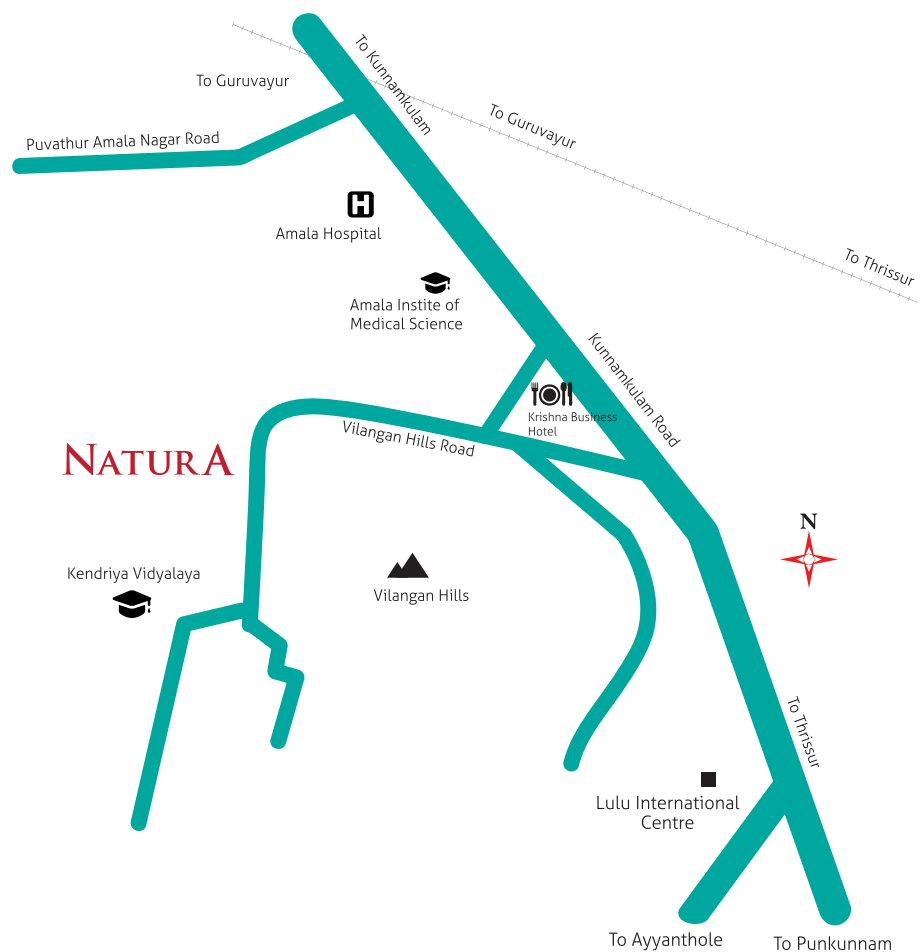

## Connectivity

Amala Medical College : 0.8 km  
Kendriya Vidyalaya : 0.2 km  
Sobha City Mall : 1.5 km  
Vilangan Hill : 0.3 km  
Guruvayur Temple : 21 km

Nationalised Bank/ATM : 0.7 km  
Railway Station : 6 km  
Thrissur Bus Stand : 7.5 km  
Cochin Airport : 60 km



## Master Plan

### Amenities

1. RMU
2. Recreation Area
3. Childrens Play Area
4. Earth Mound
5. Informal Seating Area
6. Swimming Pool
7. Toddlers Pool
8. Landscaped Jogging Track
9. Passenger Lift
10. Security Booth

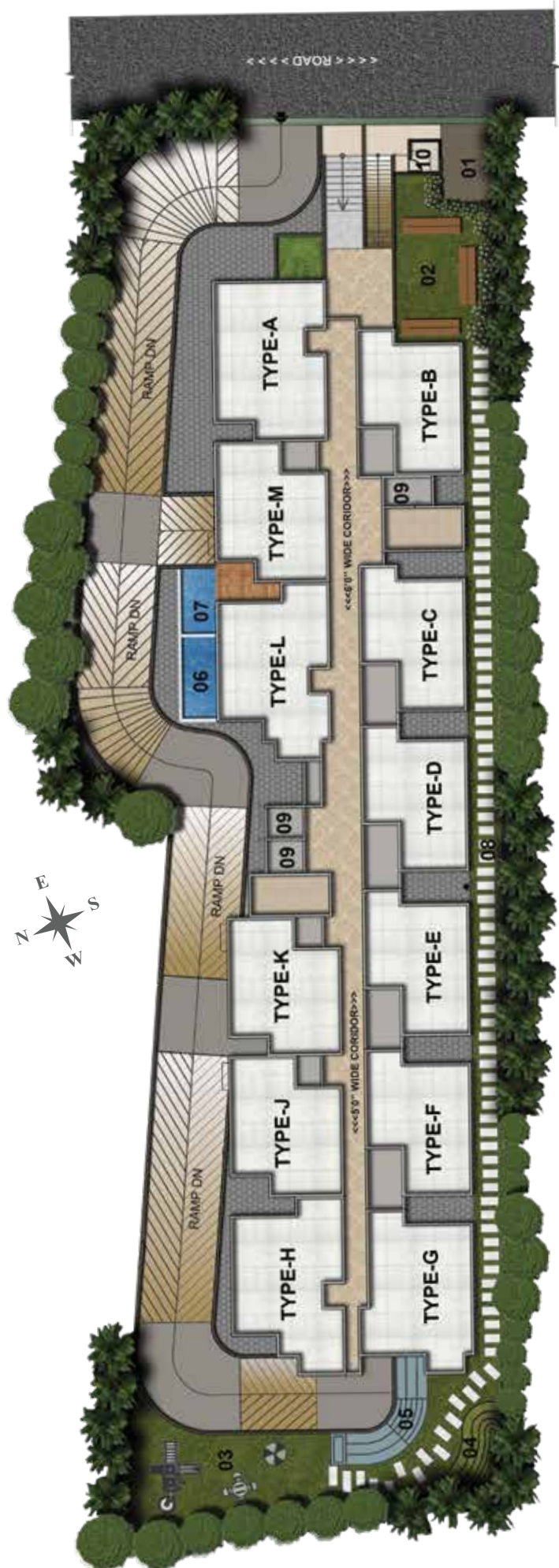

## Basement Plan

### Amenities

1. Electrical Yard
2. Pump Room
3. UG Sump-1
4. UG Sump-2
5. Deck
6. Swimming Pool
7. Toddlers Pool
8. Unisex Gymnasium
9. Lockers
10. Ladies Toilet
11. Gents Toilet
12. Open Shower
13. Indoor Games

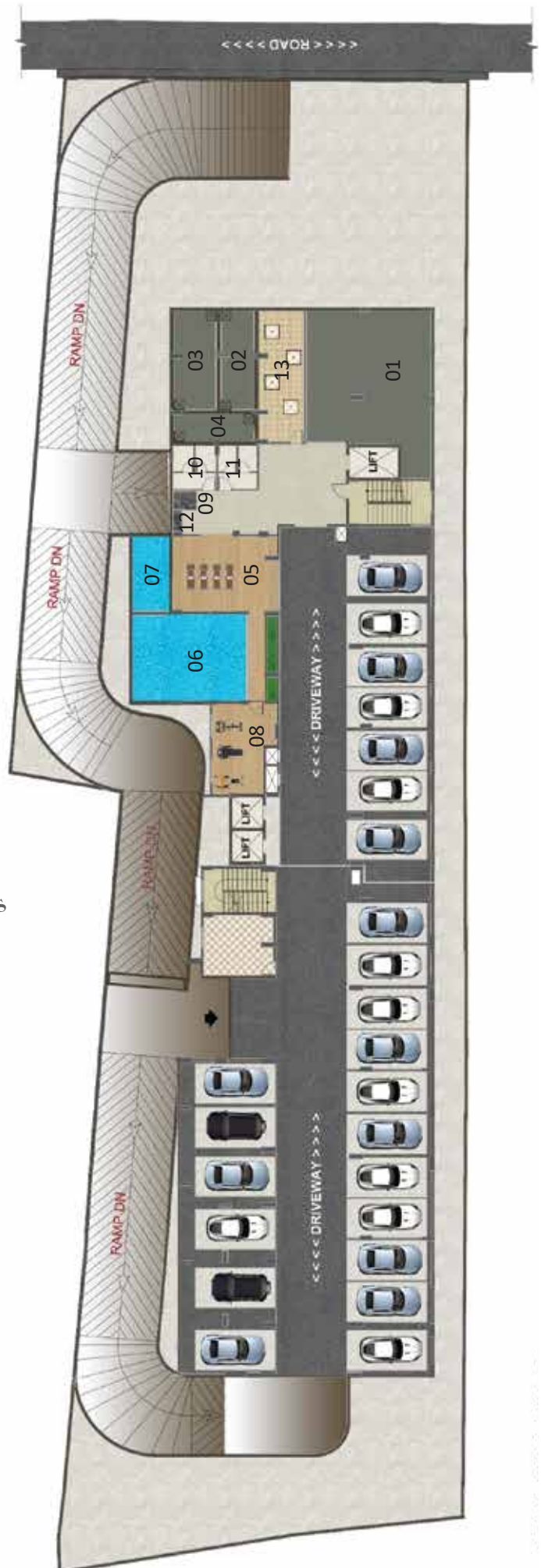



# NATURA

## Ground Floor Plan



# NATURA

## Typical Floor Plan

2 BHK : Type B  
Type C  
Type D  
Type E  
Type F  
Type J  
Type K  
Type M

3 BHK : Type A  
Type G  
Type H  
Type L





Project Highlights

Total Site Area : 2260.24 Sq.m  
(55.85 cent)  
Total Saleable Area : 24329.22 Sq.ft  
Total No. of Floors : 9 No  
Typical 1<sup>st</sup> to 5<sup>th</sup> Floor  
Ground Floor  
Upper Basement  
Mid Basement  
Lower Basement  
Total Building Height : 15.90 m (From Road Level)  
Total No. of Units : 74  
Total No. of Car Parking : 74

	Avg. Saleable Area	No.of Apts.	Percentage
2BHK	827 - 878 Sq.ft	48	65%
3BHK	1020 - 1090 Sq.ft	26	35%



# NATURA

## Unit Plan

Type A : 3 BHK  
Saleable Area : 1090 Sq.ft  
Floors : GF to 5th

Key Plan

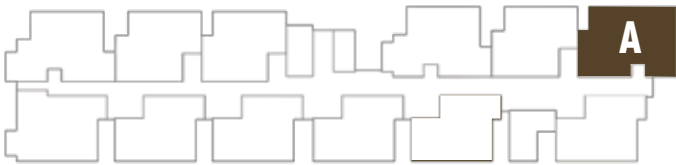

# NATURA

## Unit Plan

Type B : 2 BHK  
Saleable Area : 827 Sq.ft  
Floors : GF to 5th

Key Plan





# NATURA

## Unit Plan

Type C : 2 BHK  
Saleable Area : 827 Sq.ft  
Floors : GF to 5th

Key Plan

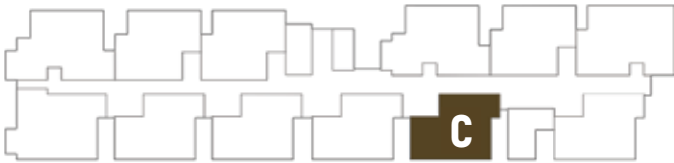

# NATURA

## Unit Plan

Type D : 2 BHK  
Saleable Area : 827 Sq.ft  
Floors : GF to 5th

Key Plan

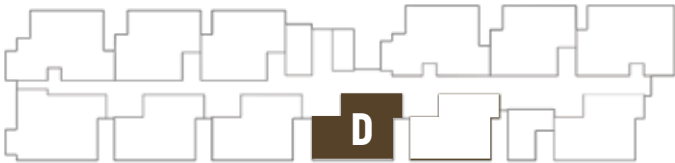

# NATURA

## Unit Plan

Type E : 2 BHK  
Saleable Area : 827 Sq.ft  
Floors : GF to 5th

Key Plan





# NATURA

## Unit Plan

Type F : 2 BHK  
Saleable Area : 827 Sq.ft  
Floors : GF to 5th

Key Plan



# NATURA

## Unit Plan

Type G : 3 BHK  
Saleable Area : 1020 Sq.ft  
Floors : UB, GF to 5th

Key Plan



# NATURA

## Unit Plan

Type H : 3 BHK  
Saleable Area : 1065 Sq.ft  
Floors : UB, GF to 5th

Key Plan

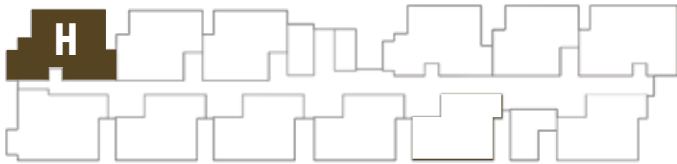



# NATURA

## Unit Plan

Type J : 2 BHK  
Saleable Area : 878 Sq.ft  
Floors : GF to 5th

Key Plan



# NATURA

## Unit Plan

Type K : 2 BHK  
Saleable Area : 878 Sq.ft  
Floors : GF to 5th

Key Plan

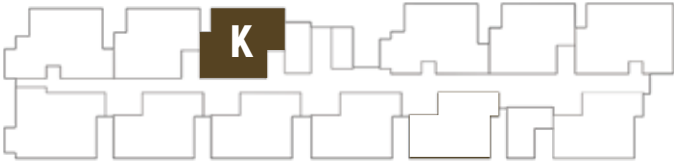

# NATURA

## Unit Plan

Type L : 3 BHK  
Saleable Area : 1065 Sq.ft  
Floors : GF to 5th

Key Plan

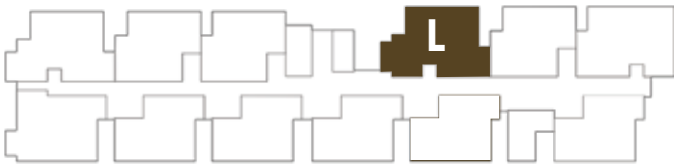



# NATURA

## Unit Plan

Type M : 2 BHK  
Saleable Area : 878 Sq.ft  
Floors : GF to 5th

Key Plan

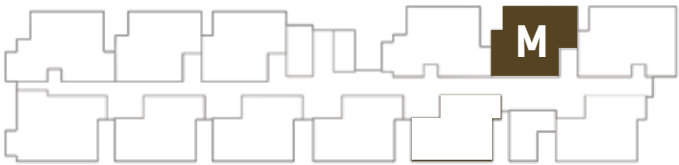



NATURA





## Sowparnika Projects - Kerala



Sowparnika Valle  
Kottayam



Sowparnika Elania  
Changanassery



Sowparnika Natura  
Thrissur



Sowparnika Atrium  
Cochin



Sowparnika Sudarsanam  
Guruvayur



Sowparnika Seychelles  
Trivandrum



Sowparnika Sandal Tower  
Trivandrum



Sowparnika Navarathnam Pearl  
Trivandrum



Sowparnika West Holmes  
Trivandrum



Sowparnika Grand Square  
Trivandrum



Sowparnika Highlands  
Trivandrum



Sowparnika Edifice  
Thrissur



Sowparnika Travancore Heights  
Changanassery



Sowparnika Grand Square  
Trivandrum



Sowparnika Shirdi  
Trivandrum



Sowparnika Shirdi Phase-2  
Trivandrum



Sowparnika City Crown  
Trivandrum



Sowparnika River View Garden  
Trivandrum



Sowparnika Regal  
Trivandrum



Sowparnika Surya Kiran  
Trivandrum



Sowparnika Promenade Square  
Trivandrum



Sowparnika Bhavani  
Trivandrum

# Value Creation

Turnkey Delivery - From Design to Execution



Silicon India with LICHFL



Brands Academy Awards



Indian Achievers' Podium



ET Now



ET Now



NDTV Profit Real Estate Award



Junior Chamber International  
Kottayam



Kerala Financial Corporation  
Trivandrum

[www.sowparnika.com](http://www.sowparnika.com)

# 93435 15152

**Sowparnika Natura**, Vilangan Amusement Park Road, Near Kendriya Vidyalaya Amala Nagar,  
P.O. Thrissur - 680 555,

**6000+** SATISFIED CUSTOMERS

**35+** COMPLETED PROJECTS

**35+** ONGOING PROJECTS

**50+** LAKH SQ. FT. DEVELOPED

**50+** LAKH SQ. FT. UNDER DEVELOPMENT

**3** STATES PRESENCE